

3003748

TOWN : HAIFA
LOCALITY : DROM AHUZA
OWNERS : SHEVETH-AHIM CO

HAIFA AND SAMARIA DISTRICT
TOWN PLANNING COMMISSION
PROVISIONAL APPROVAL.
Scheme No. 588 Passed for Publication
at the 31st meeting of the
Commission held on 4.7.39
Betterment Tax may be recovered in respect of this
Scheme in accordance with the provisions of section 52
of the Town Planning Ordinance, 1936.
Adviser: [Signature]
Chairman: [Signature]

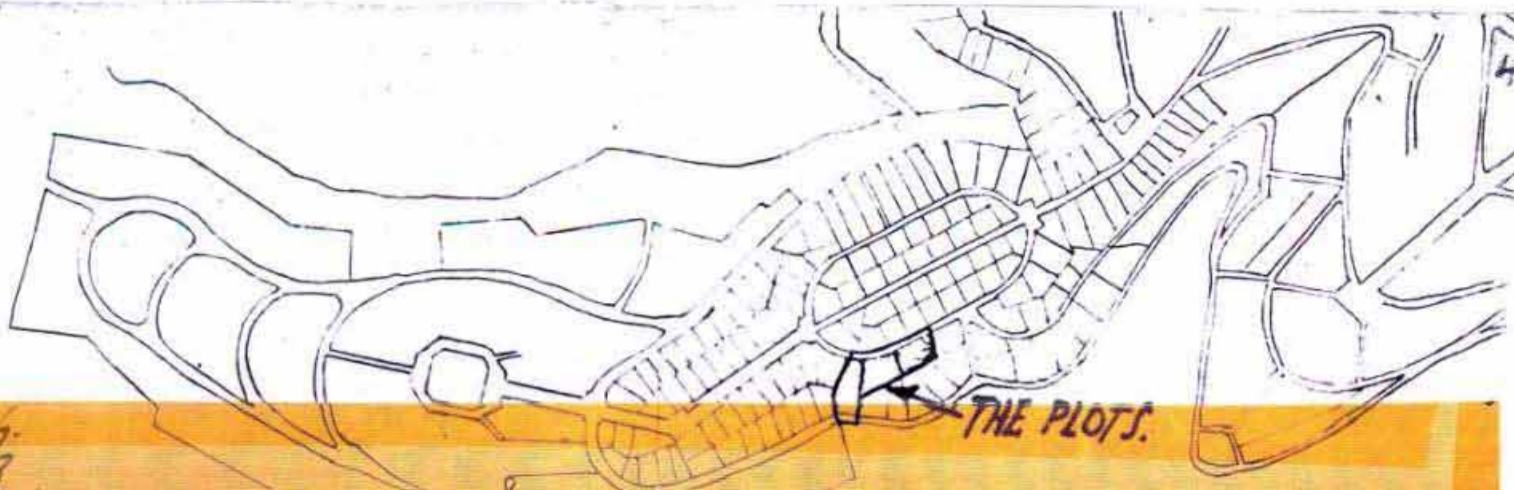

LOCATION PLAN 1:10000

SCALE 1/1000

REPARCELLATION OF PLOTS Nos. 54, 55 & 56 OF SCHEME No. 10, HAMANHIL MEMORAH LAND.

TOWN PLANNING SCHEME No. 588

HAIFA LOCAL TOWN PLANNING COMMISSION
APPROVED ON 10-3-42
FOR ENACTMENT
SCHEME No. 588.
[Signatures]

HAIFA LOCAL TOWN PLANNING COMMISSION
APPROVED ON 14-6-39
FOR PROVISIONAL APPROVAL BY D.T.P.C.
SCHEME No. 588
[Signatures]

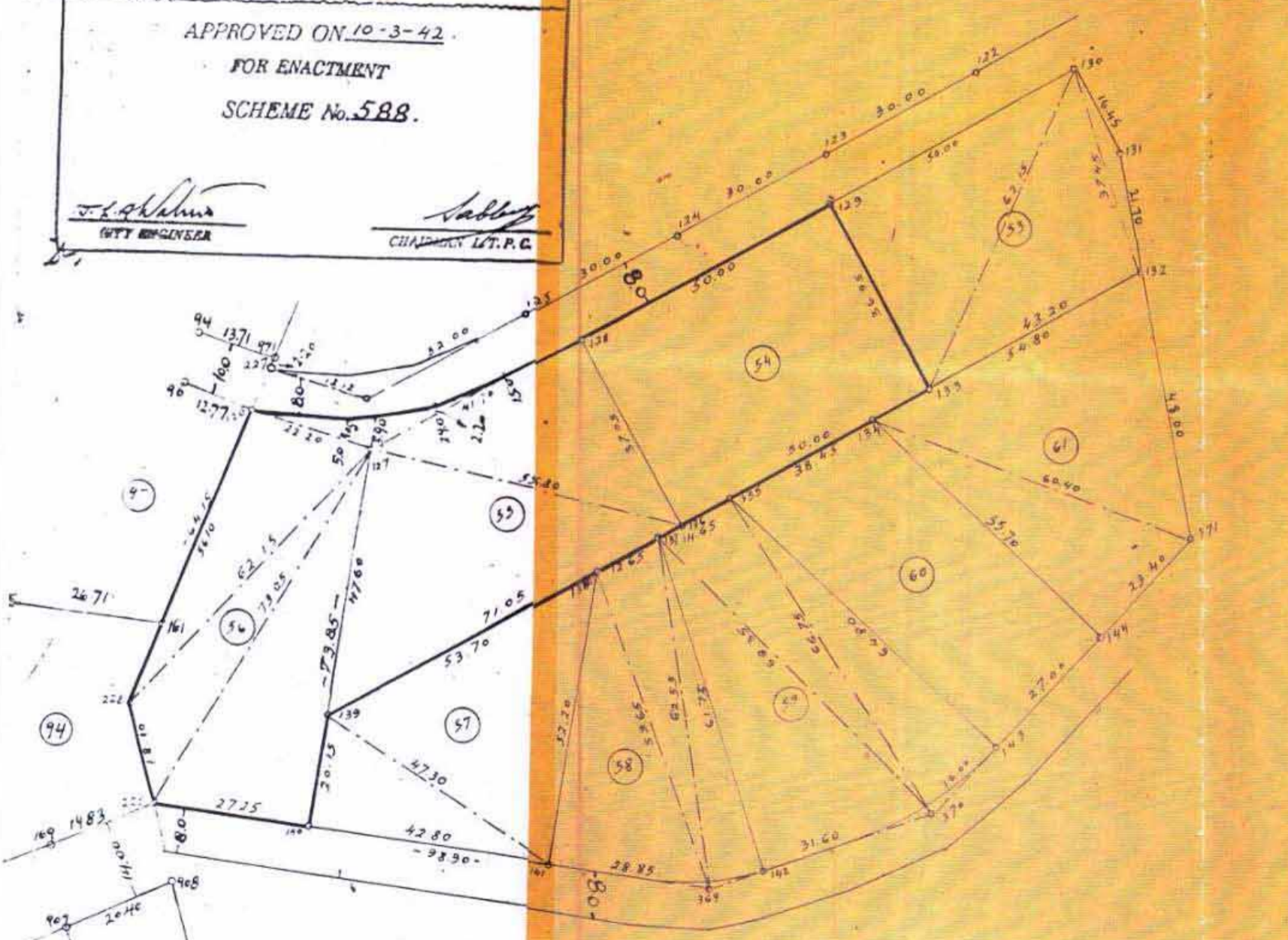

OLD POSITION.

54.	1845 m ²
55.	2151 m ²
56.	2072 m ²
TOTAL AREA	6068 m ²

LEGEND
BOUNDARY OF SCHEME
SET BACKS
EXISTING ROAD
NEW STREETS
ZONE A
BUILDING LINE
WIDTH OF ROAD
NUMBER OF ROADS
HIGH TENSION ELECTRIC LINE

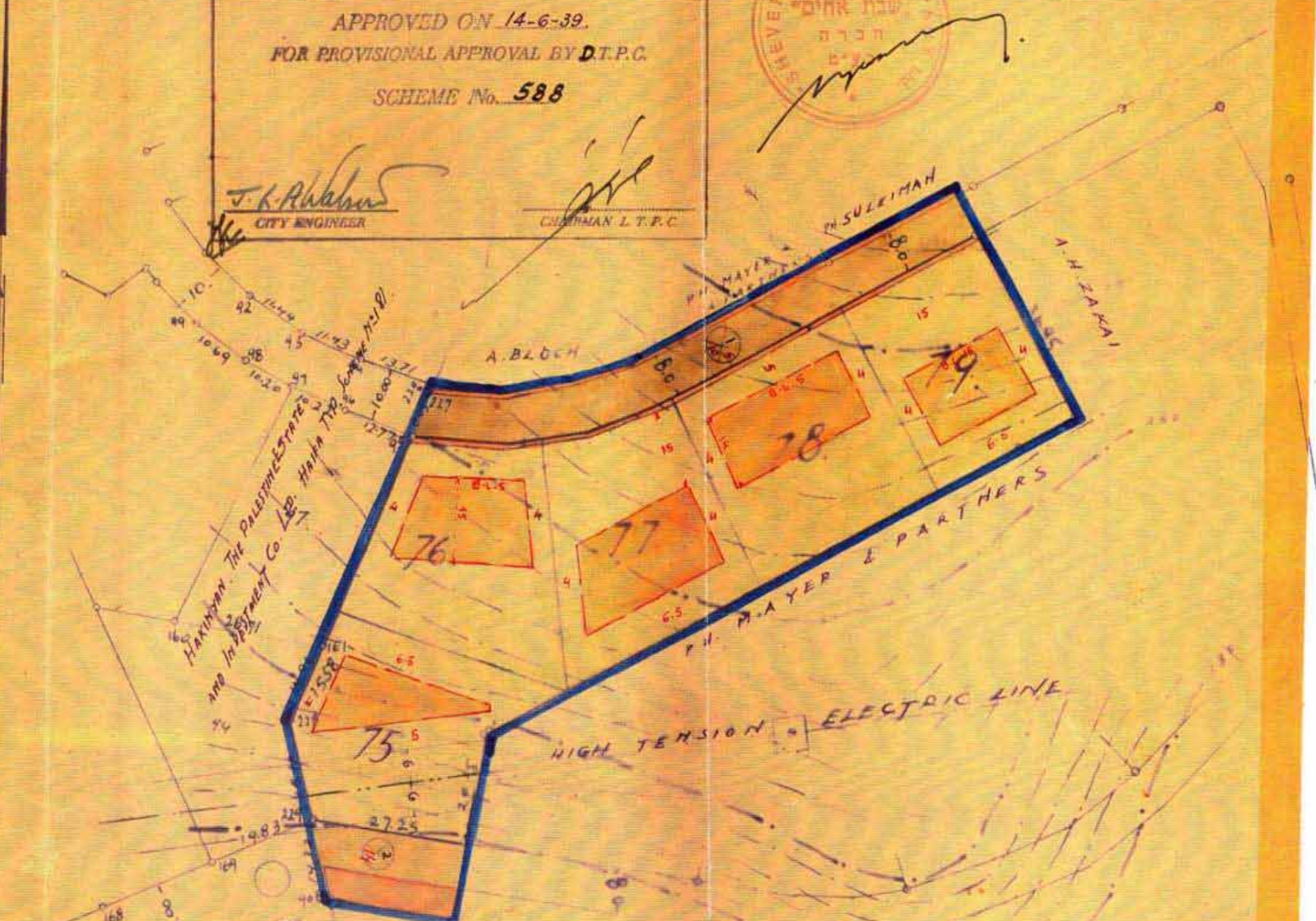

HAIFA DISTRICT
TOWN PLANNING COMMISSION
Scheme No. 588 Date: 12.5.39
FINALLY APPROVED SCHEME
BETTERMENT TAX may be recovered in respect of this
Scheme in accordance with the provisions of section 52
of the Town Planning Ordinance, 1936.
[Signatures]

DISTRICT BUILDING
TOWN PLANNING COMMISSION
HAIFA
District Serial No. of Scheme: HA/208
District File No.: 271/440

588
HAIFA, 12-5-39