

MUNICIPAL CORPORATION OF HAIFA.
 PLAN ATTACHED TO
 HAIFA DETAILED TOWN PLANNING SCHEME No.673.
 STAIRWAY CONNECTING ARLOSOROFF AND BAR GIORA STREETS.
 SCALE 1:250.

DISTRICT BUILDING
 AND
 TOWN PLANNING COMMISSION
 HAIFA DISTRICT
 District Serial No. of Plan HA/334
 District File No. 27/621

IMPORTANT NOTICE.
 Have you studied the regulations
 which form part of this scheme?
 Do they permit you to build now
 and under what conditions?

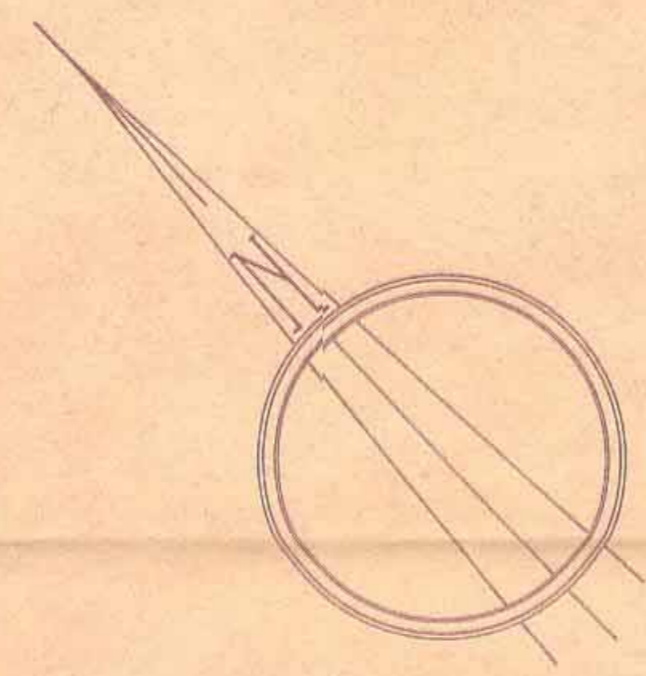

TOWN PLANNING ORDINANCE, 1936.
 Haifa TOWN PLANNING AREA.
 Detailed Scheme No. 673
 The District Commission, at its meeting held on the 10th day of July 1934, resolved to grant authority to put the above scheme into force.
 G. Novikov Chairman
 Town Planning Advisor
 A. Ben-Zion Chairman
 Haifa District Building and Town Planning Commission.

HAIFA LOCAL BUILDING & TOWN PLANNING COMMISSION
 H. T. P. SCHEME No. 673
 RECOMMENDED TO BE PUT INTO FORCE
 AT THE 85th MEETING ON 12.9.44
 City Engineer: [Signature]
 Chairman L.B. & T.P.C.: [Signature]

TOWN PLANNING ORDINANCE, 1936.
 Haifa TOWN PLANNING AREA.
 Detailed Scheme No. 673
 The District Commission, at its meeting held on the 14th day of April 1934, resolved to deposit the above scheme.
 A. Meudall Chairman
 Town Planning Advisor
 A. Ben-Zion Chairman
 Haifa District Building and Town Planning Commission.

HAIFA LOCAL TOWN PLANNING COMMISSION
 APPROVED ON 14-3-44
 FOR PROVISIONAL APPROVAL BY D.T.P.C.
 SCHEME No. 673
 City Engineer: [Signature]
 Chairman D.T.P.C.: [Signature]

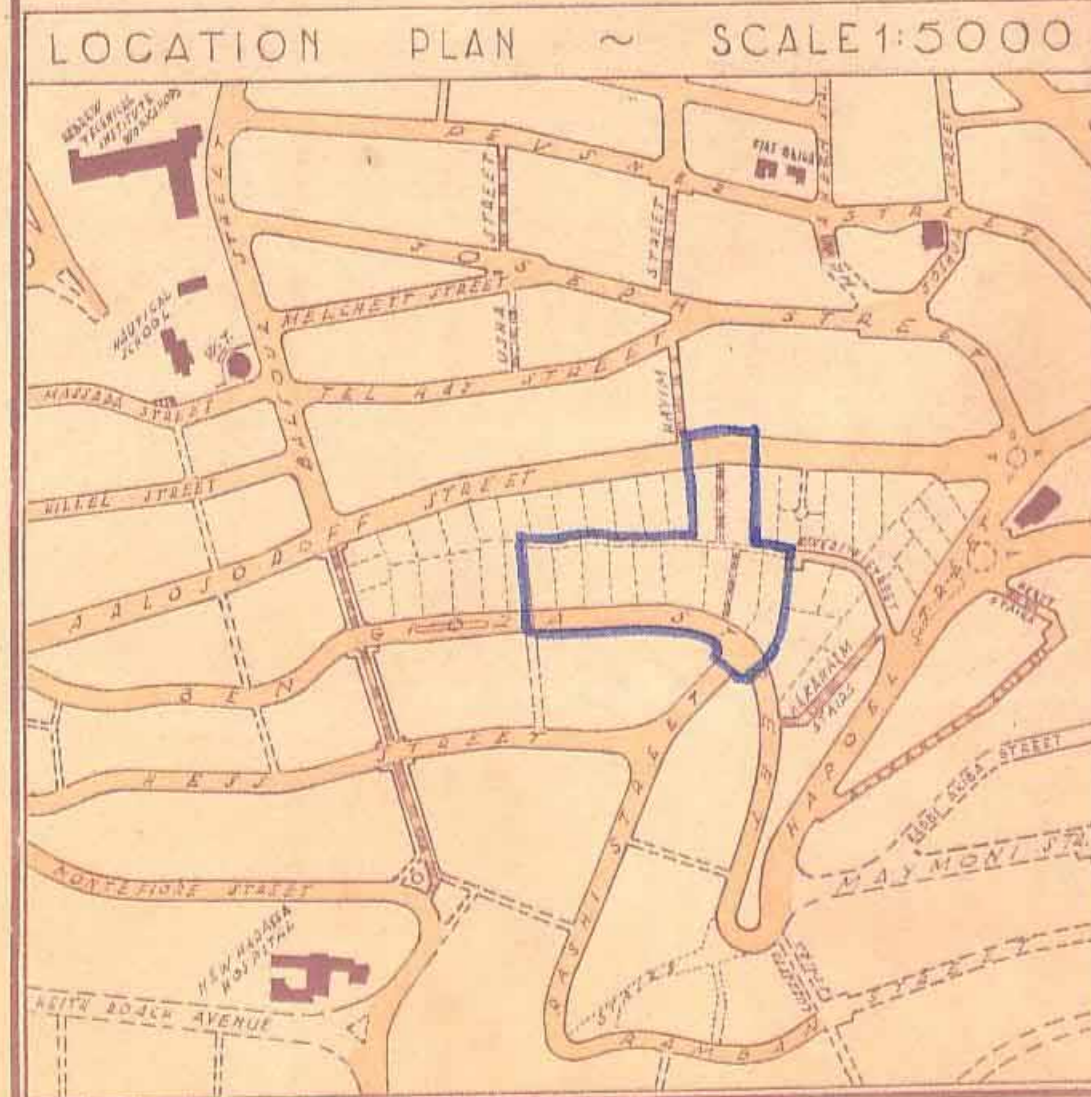
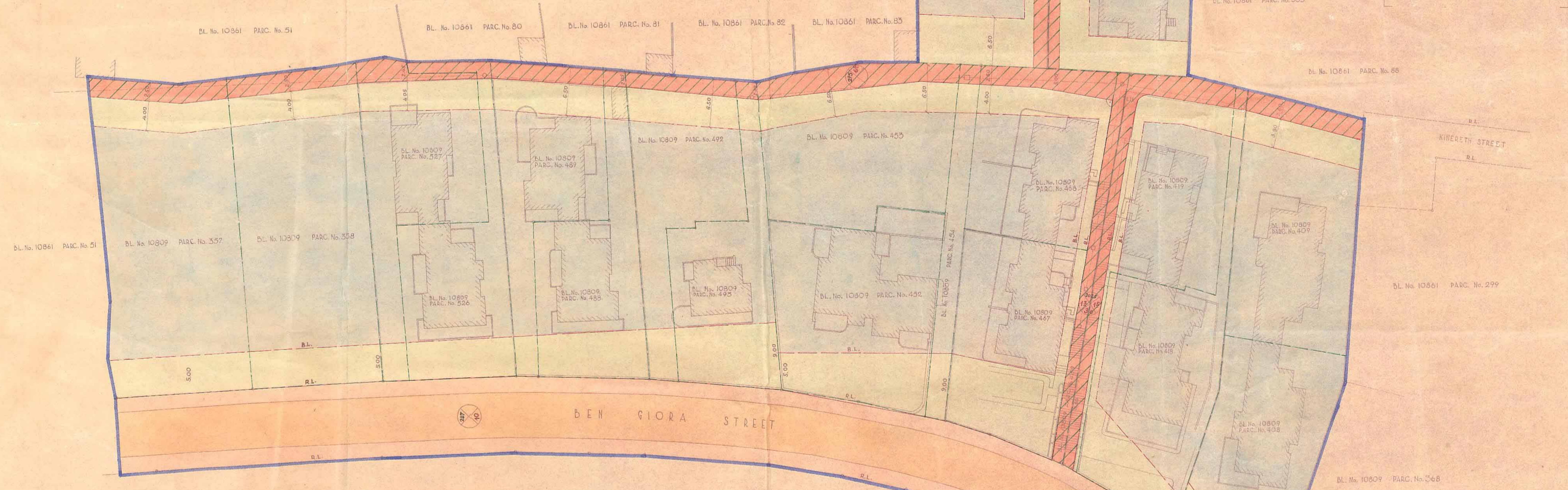

- REFERENCE
- RESIDENTIAL ZONE 'B'
 - PREScribed SET BACK
 - NUMBER OF ROAD
 - WIDTH OF ROAD
 - FRONT SET BACK
 - ROAD LINE
 - BUILDING LINE
 - EXISTING PAVED ROAD
 - APPROVED ROAD
 - NEW FOOTPATH
 - SEWER
 - BOUNDARY OF PROPERTY
 - BOUNDARY OF SCHEME

MUNICIPAL CORPORATION OF HAIFA
 ENGINEERING DEPARTMENT
 TOWN PLANNING SECTION
 STAIRWAY CONNECTING ARLOSOROFF & BAR GIORA STREET
 SCALE 1:250
 Date: []/ []/ []
 Drawn by: A.M.
 Checked by: A.B.
 673
 FEBRUARY 1944