

207/04

71207

33

DISTRICT : NORTHERN
 TOWN : HAIFA
 LOCALITY : EMEK ZEBULON
 OWNER : HOCHFELD
 SCALE : 1:1000

HAIFA LOCAL TOWN PLANNING COMMISSION
 APPROVED ON 14.10.36.
 FOR ENACTMENT
 SCHEME No. 207
J. K. Ahabas
 CITY ENGINEER
S. Kallay
 CHAIRMAN & T.P.C.

DISTRICT BUILDING and TOWN
 PLANNING COMMISSION
 NORTHERN DISTRICT
 District Serial No. of Plan 111/35
 District File No. 271/212

מחוז : צפון
 עיר : חיפה
 מקום : עמק זבולון
 בעל הקרקע : הוכפלד
 קטן 11000

IKK.L. AND PART.

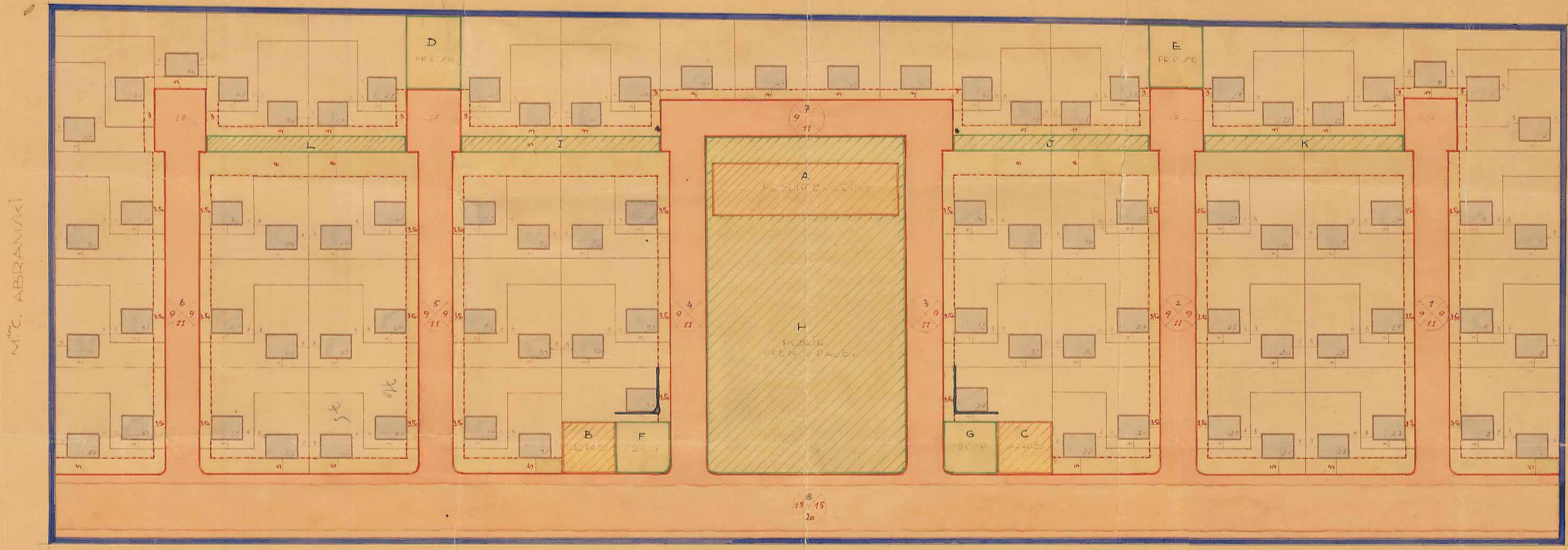

LEGEND

- BOUNDARY OF THE SCHEME
- EXISTING ROAD
- PROPOSED ROAD
- ROAD LINE
- PUBLIC OPEN SPACE
- PRIVATE " "
- SET BACK
- BUILDING LINE
- RESIDENTIAL AREA
- HOUSE
- SHOP FRONTAGE
- PUBLIC BUILDING
- NUMBER OF TREES
- DE/ TABLE BETWEEN BUILDING AND ROAD CENTER
- WIDTH OF ROAD

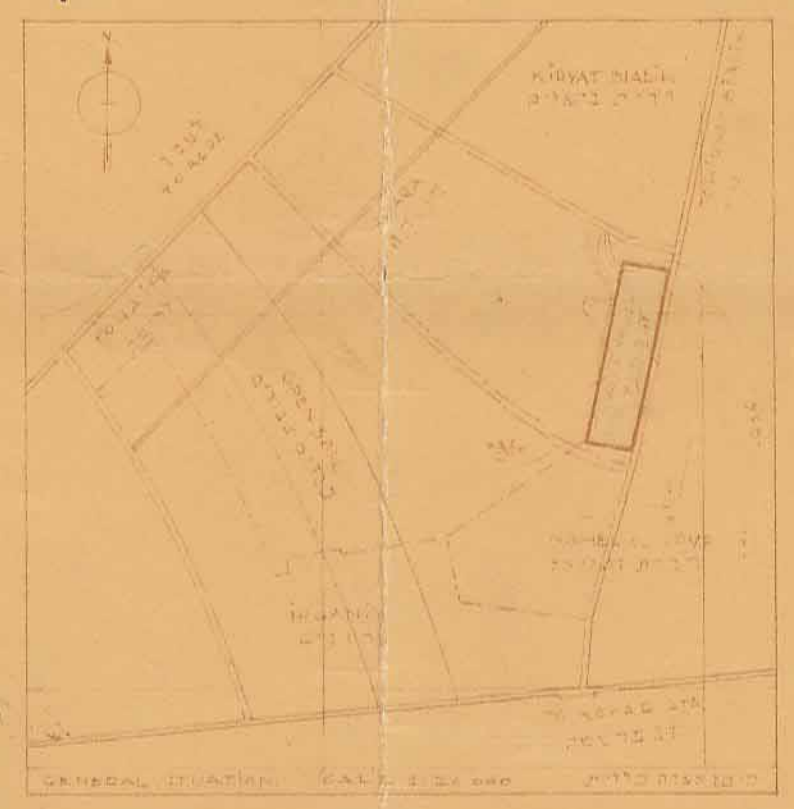

NORTHERN DISTRICT
 TOWN PLANNING COMMISSION
 FINAL APPROVAL
 Scheme No. 207
 Finally approved
 and ordered to be published
 in the gazette.
 Date _____ Chairman _____

NORTHERN DISTRICT
 TOWN PLANNING COMMISSION
 No. 207 Date 17/11/36
APPROVED PLAN
A. Kallay Chairman *H. Kendall* Adviser

SCHEME PREPARED BY ALEX. KLEIN
 11, BALFOUR STR. HOUSE, SIRAH HAD. HAC.
 THE 17 JAN. 1936

TOTAL AREA	77,200 M ²
RESIDENTIAL AREA	34 PLOTS EACH OF 600 M ² 50,400
SITE FOR PUBLIC BUILDING	1,272 52,672
ROADS AND OPEN SPACES	19,528 M ²

שפת כללי
 בגרשי הדירות 74,200 מ² כל אחד 600 מ²
 הבניינים צבורים
 דרכים ופנויים 19,528 מ²

207