

TOWN PLANNING SCHEME nr 521 מ'ס 521 תכנית בנין ערים
 EAST HAIFA מזרח חיפה
 PREPARED BY EAST HAIFA DEV. CO. הוגש על-ידי חברת פתוח מזרח חיפה

Scale: 1:1250 ק"מ

HAIFA AND HAIFA DISTRICT
 TOWN PLANNING COMMISSION
 PROFESSIONAL APPROVAL
 Scheme No. 521 Passed for Publication
 on the 21st meeting of the
 Commission held on 12.1.57
 Chairman

HAIFA AND HAIFA DISTRICT T.P.C.
 Meeting No. 22 held on 21.1.57
 FULLY APPROVED SCHEME
 Chairman

HAIFA AND HAIFA DISTRICT TOWN PLANNING COMMISSION
 APPROVED ON 21.1.57
 FOR PUBLICATION
 SCHEME NO. 521

DISTRICT BUILDING
 AND
 TOWN PLANNING COMMISSION
 HAIFA AND HAIFA DISTRICT
 Date of Issue No. 521/57
 29/1/57

1:1250
 1:1250



Area of
 10000 sq. m.
 2500 sq. m.
 10000 sq. m.
 2500 sq. m.

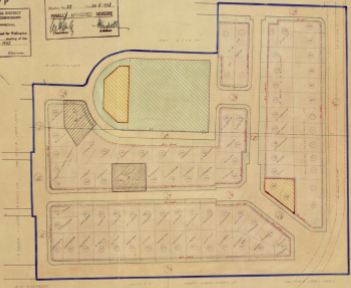

TOTAL AREA = 104 ACRES: 150,500 sq. m.

APPROVED FOR PUBLICATION
 ON 21.1.57
 FOR PUBLICATION
 SCHEME NO. 521