

NATHANYA TOWN PLANNING AREA

TOWN PLANNING SCHEME, NO 303

303

28

PROMOTERS:

- MRS. LEAH BEN-AVI
- " LEVANAN GEDALYA
- MR. JSRAEL HAYIMOVITZ
- " A. HIRSCHBERG
- " J. BEN-JAMIN
- " I. BARAN

SCALE 1:1000

SCHEDULE OF AREAS				
	PARCEL	AREA	TOTAL	
ORI-	8258/46	670		
	8259/48	650		
GI-	49	600		
	50	600		
NAL	51	600		
	52	600		
PAR-	53	600		
	54	600		
CELS	55	670		
	56	700		
NEW	57	600		
	58	600		
	59	600		
	60	600		
	61	600		
	62	600		
	63	710		
	P.O.S. ROADS	1950	12550	
	8258			
	8259/1	1244		
	8259/2	1000		
NEW	3	1000		
PAR-	4	1061		
	5	930 892 E		
CELS	6	839		
	7	839		
NEW	8	720		
	9	720		
	10	720		
	11	893 892 E		
ROADS	2597			
A	10	12550		

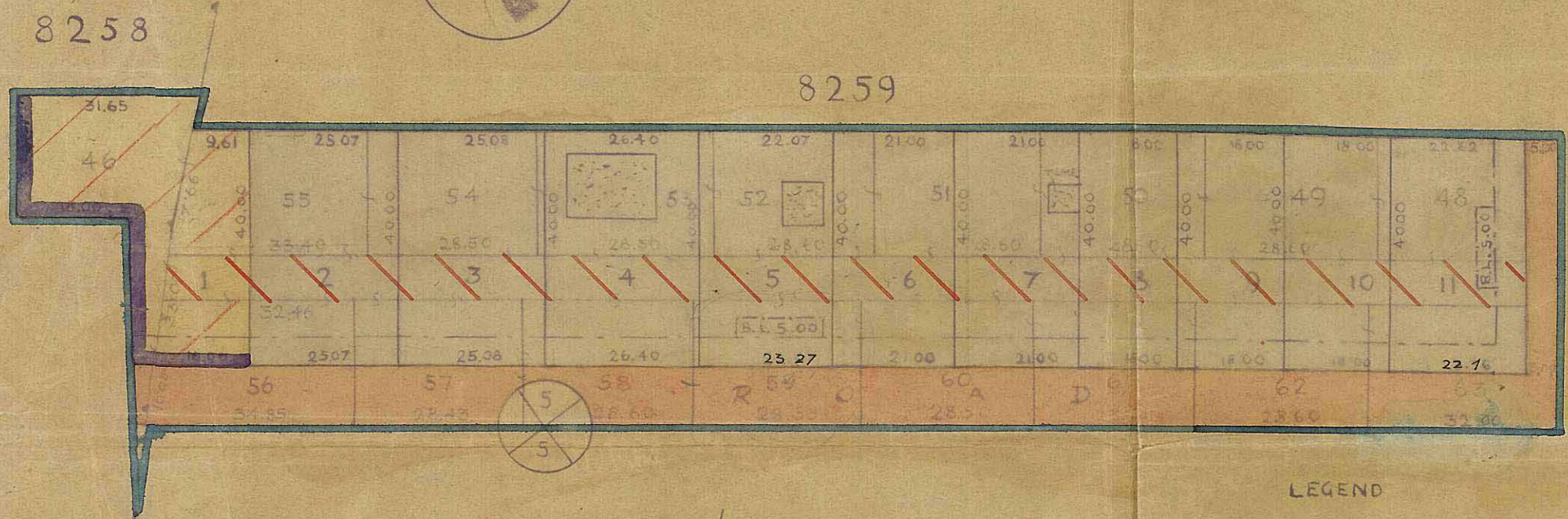

KEY PLAN
1:5000

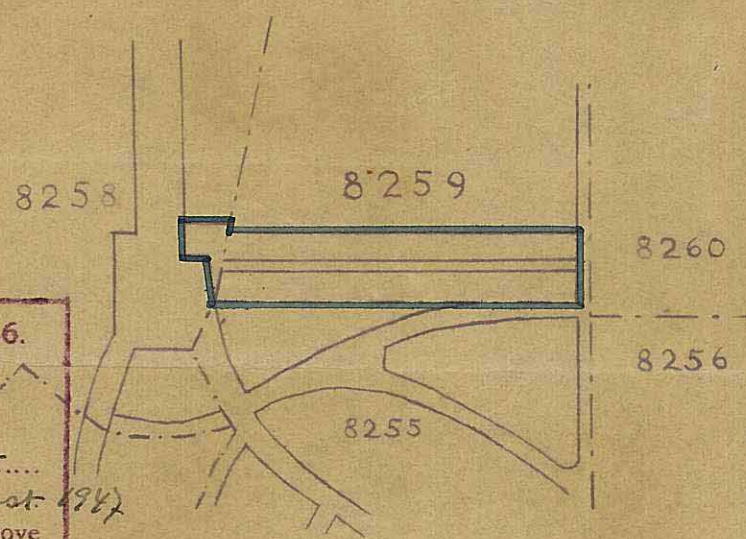

LEGEND

- SCHEME BOUNDARY
- ROAD TO BE STOPPED UP
- RESIDENTIAL ZONE B.
- NEW ROAD
- BUILDING LINE
- ROAD NO.
- BUILDING LINE
- WIDTH OF ROAD
- EXISTING BUILDINGS
- RESIDENTIAL ZONE A
- SITE FOR PUBLIC BUILD.

under architectural control.

PROMOTERS:

ישראל בן-אמר
לוי גדליה
ג'ורג' אבי
א. הירשברג
י. בן-ימין
א. ברן

DESIGNER:

Dr. HAIM BEN-ANAR
(BLUMENTFELD)
Dipl. ARCHITECT, Nathanya
29. SEP. 1946
Date

TOWN PLANNING ORDINANCE, 1936.
NATHANYA TOWN PLANNING AREA.
Detailed Scheme No. 303
The District Commission, at its 31st meeting held on 14.15 day of August 1946 resolved to grant authority to put the above scheme into force.
M. Gedalia
Chairman
Samarita District Building and Town Planning Commission.
Town Planning Adviser.

NATHANYA LOCAL TOWN PLANNING COMMISSION
Scheme passed to District Commission for provisional approval at the 41st meeting held on 20/27 Mar. 46
Muller
Chairman

TOWN PLANNING ORDINANCE, 1936.
NATHANYA TOWN PLANNING AREA.
Detailed Scheme No. 303
The District Commission, at its 27th meeting held on the 4th day of July, 1946 resolved to deposit the above scheme.
Ben-Haim
Chairman
Samarita District Building and Town Planning Commission.
Town Planning Adviser.