

DISTRICT LYDDA
 SUB. DIST. JAFFA
 LOCALITY HERZLIYA
 BLOCK 6538
 PLOT 49
 PROMOTER MR. A. REIS

מחוז נפה מושבה גוש חלקה הוכן עבור
 ליד 19' הרצליה 6538 49 מר. א. רייס

HERZLIYA TOWN PLANNING AREA
 PLAN OF PARCELLATION SCHEME NO. 87

SITUATION PLAN - תנשים-המקום
 SCALE 1:5000 ק.מ.

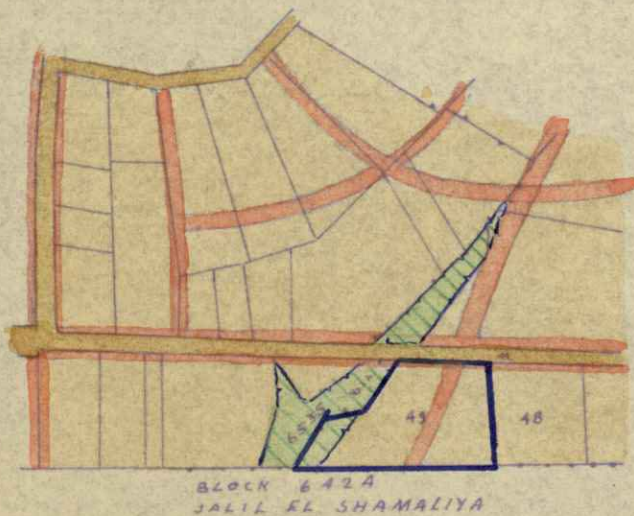

SCALE 1:1250 ק.מ.

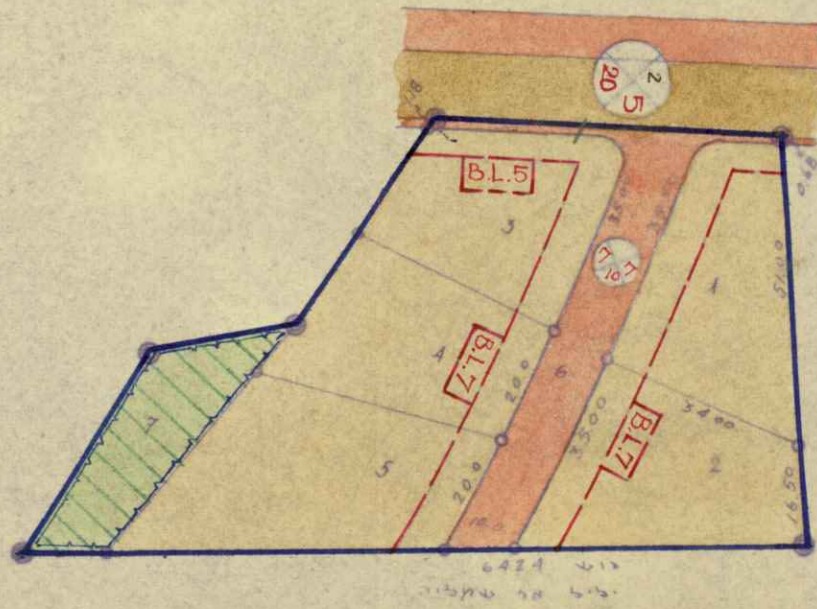

SUB-DIVISION - חלוקה

שטח בדונ"ק	חלק מ
1000	1
1000	2
1000	3
1000	4
1156	5
0825	6
0614	7
6595	כ"ט

LEGEND

- BOUNDARY OF SCHEME גבולות התכנית
- PUBLIC Q. SPACE מגרש צבורי
- NEW ROADS דרכים חדשות
- EXISTING ROADS דרכים קיימות
- ROAD WIDENINGS הרחבת דרכים
- NUMBER OF ROAD מספר קדק
- BUILDING LINE קו הבנין
- WIDTH OF ROAD רוחב קדק
- BUILDING LINE קו בנין
- RESIDENTIAL ZONE A. אזור מאורים א.

HERZLIYA LOCAL BUILDING & TOWN PLANNING COMMISSION

Scheme No. 87 passed to the District Commission for provisional approval
 Meeting No. 13 Date 14.9.45

[Signature] Chairman

HERZLIYA LOCAL BUILDING & TOWN PLANNING COMMISSION

Scheme No. 87 passed to the District Commission for provisional approval
 Meeting No. 14 Date 30.12.45

[Signature] Chairman

TOWN PLANNING ORDINANCE, 1936.
 Herzliya... TOWN PLANNING AREA.
 Parcellation... SCHEME No. 87.
 The District Commission, at its 103rd meeting held on the 25th day of Oct. 1945 resolved to deposit the above scheme.
 (Sgd.) E. KENDALL (Sgd.) R. C. H. GREIG
 Town Planning Adviser. Chairman
 Lydda District Building and Town Planning Commission.

TOWN PLANNING ORDINANCE, 1936.
 Herzliya... TOWN PLANNING AREA.
 Parcellation... SCHEME No. 87.
 The District Commission, at its 105th meeting held on the 31st day of JAN. 1946 resolved to grant authority to put the above scheme into force.
 (Sgd.) E. KENDALL (Sgd.) R. C. H. GREIG
 Town Planning Adviser. Chairman
 Lydda District Building and Town Planning Commission.

NOT FOR REGISTRATION לא לצרכי רישום
 HERZLIYA 10.11.1945 הרצליה

[Handwritten signatures and notes in Hebrew]